

**BUILDING '2'**  
 WHOLE BLD NLA = 217.4m<sup>2</sup>  
 WHOLE BLD GLA = 241.7m<sup>2</sup>

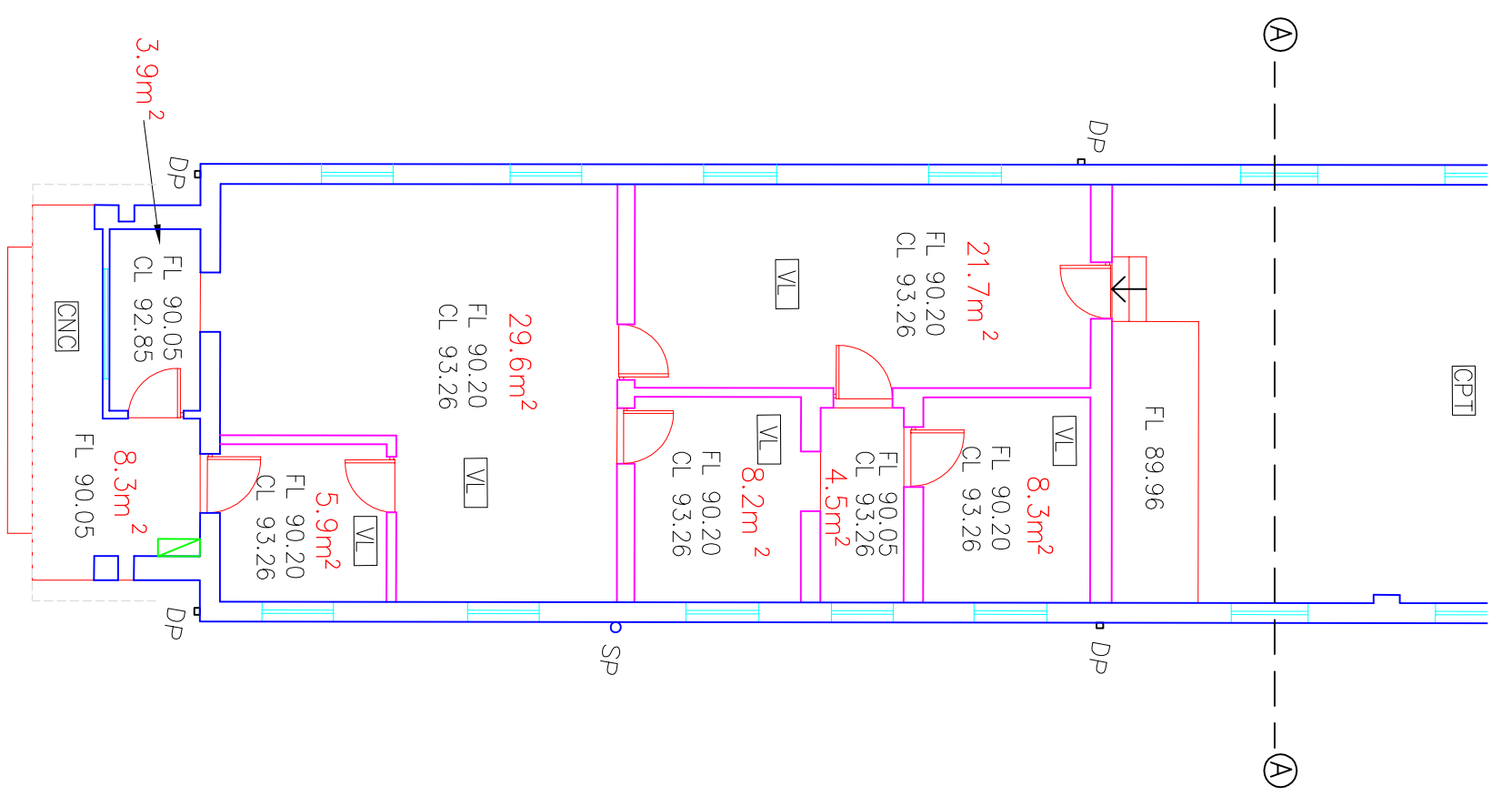
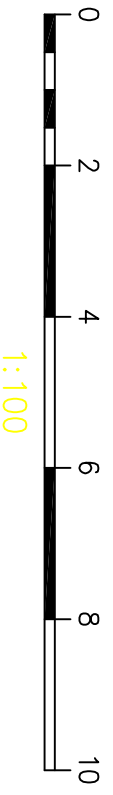

**OPT = CARPET**  
**CNC = CONCRETE FLOOR**  
**VL = VINYL FLOORING**  
**TLD = TILED FLOOR**  
**FHR = FIRE HORSE REEL**  
**EDB = ELECTRICAL DISTRIBUTION BOARD**  
**U/S = UNDERSIDE**  
**T/B = TIMBER FLOOR BOARDS**  
**BIT = BITUMEN FLOOR**

**FL = FLOOR LEVEL**  
**CL = CEILING LEVEL**  
**DP = DOWNPIPE**  
**WP = WATER PIPE**  
**FH = FIRE HYDRANT**  
**HW = HOT WATER TANK**  
**FW = FLOOR WASTE**  
**GVL = GRAVEL FLOOR**  
**DRT = DIRT FLOOR**

**DR = DOOR**  
**W = WINDOW**  
**MS = METAL SHEETING**  
**BK = BRICK**  
**CI = CORRUGATED IRON**  
**FBS = FIBRO SHEETING**  
**WB = WEATHERBOARD**  
**RL = REDUCED LEVEL**  
**RSC = ROOF SEAL COVERING**

INITIALS	DATE
TL	17/12/04
MIR	20/12/04
MRL	21/12/04
SPHT	APPROVED

**Sydney Harbour Federation Trust**  
 PO BOX 607 MOSMAN, NSW, AUSTRALIA. 2088  
 TEL (+61 2) 8969 2100 FAX (+61 2) 8969 2120

**SITE**  
 NORTH HEAD - SCHOOL OF ARTILLARY

**TITLE**  
 PLAN OF BUILDING LAYOUT AND NETT LETTABLE AREAS

**ORIG. DWG SIZE** : A3 **SCALE** 1:100 **FILE REF** 28312

**CAD FILE NAME** 28312DT **PLOT DATE** 21-12-04

