

# 8 • WATERFRONT PLAN

- ① Existing concrete wharf
- ② Interpretive linemarkings
- ③ Steel structure to building edge
- ④ Covered weatherproof walkway with glass/perspex roof against building
- ⑤ Textile shade canopy to structure
- ⑥ Tensile wire connected to structure for green edge and canopy
- ⑦ Steel planters at the base of structure
- ⑧ Lighting conduits to steel structure
- ⑨ Timber and concrete 'raft' seats
- ⑩ Timber benches
- ⑪ Timber communal tables
- ⑫ Retail moveable furniture zone
- ⑬ Concrete planter pots
- ⑭ Large feature trees in concrete pots to courtyard
- ⑮ Torpedo racks relocated to wharf with allowance for line marking and interpretation.
- ⑯ Existing access hatches re-incorporated as part of heritage interpretation

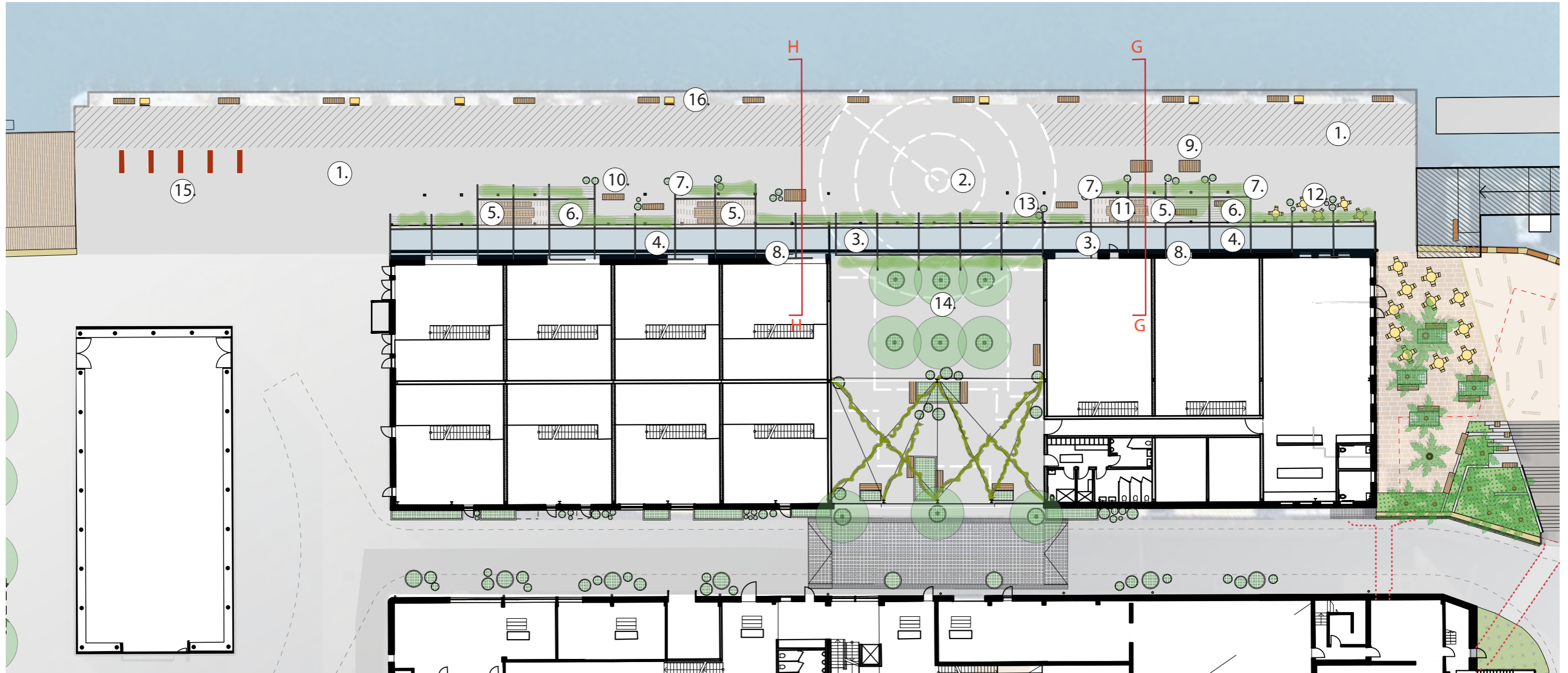

ASPECT Studios™  
**lahznimmo**  
 architects

PLATYPUS  
 33.8440° S, 151.2165° E

# 8 • WATERFRONT SECTIONS

- ① Existing concrete wharf
- ③ Steel structure to building edge
- ④ Covered weatherproof walkway with glass/perspex roof against building
- ⑤ Textile shade canopy to structure
- ⑥ Tensile wire connected to structure for green edge and canopy
- ⑦ Steel planters at the base of structure
- ⑨ Timber and concrete 'raft' seats
- ⑪ Timber communal tables

## Waterfront

The waterfront along the existing Submarine Wharf offers outlook and respite along the water's edge. A green pergola and covered walkway extends along the eastern edge of the FIMA workshop complementing the existing structure and provides a weather protected pedestrian route, shade, shelter and public outdoor rooms/workspace. Much of the existing space on the wharf is retained as open and flexible allowing for changing events and occasional large numbers of people who may congregate to view a moored vessel.

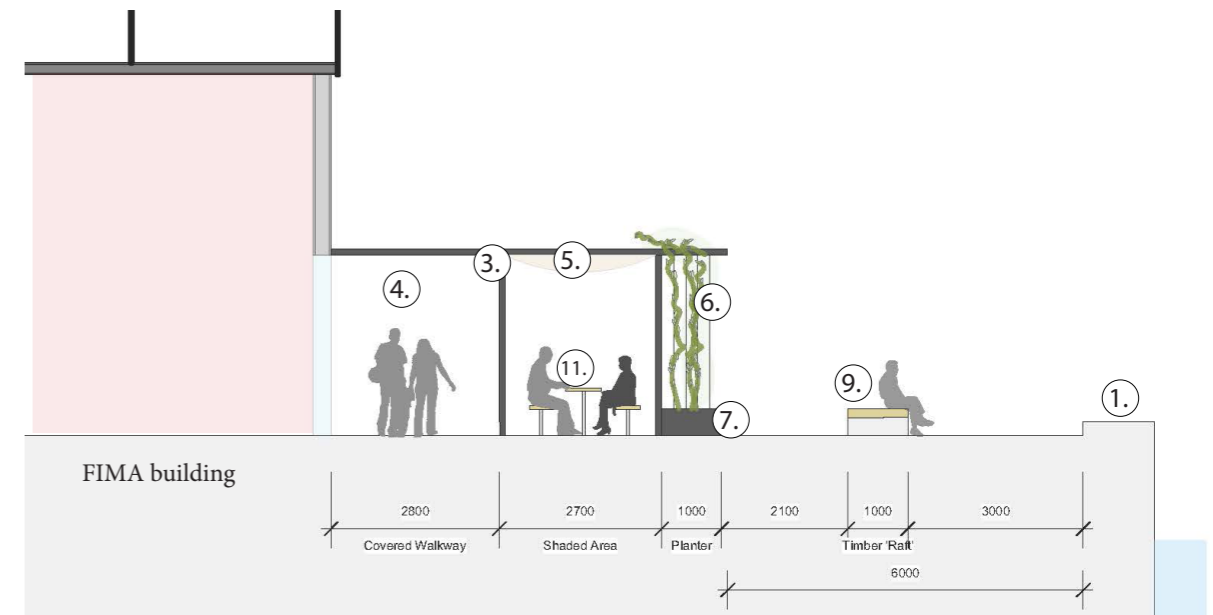

SECTION GG: Walkway + Shade

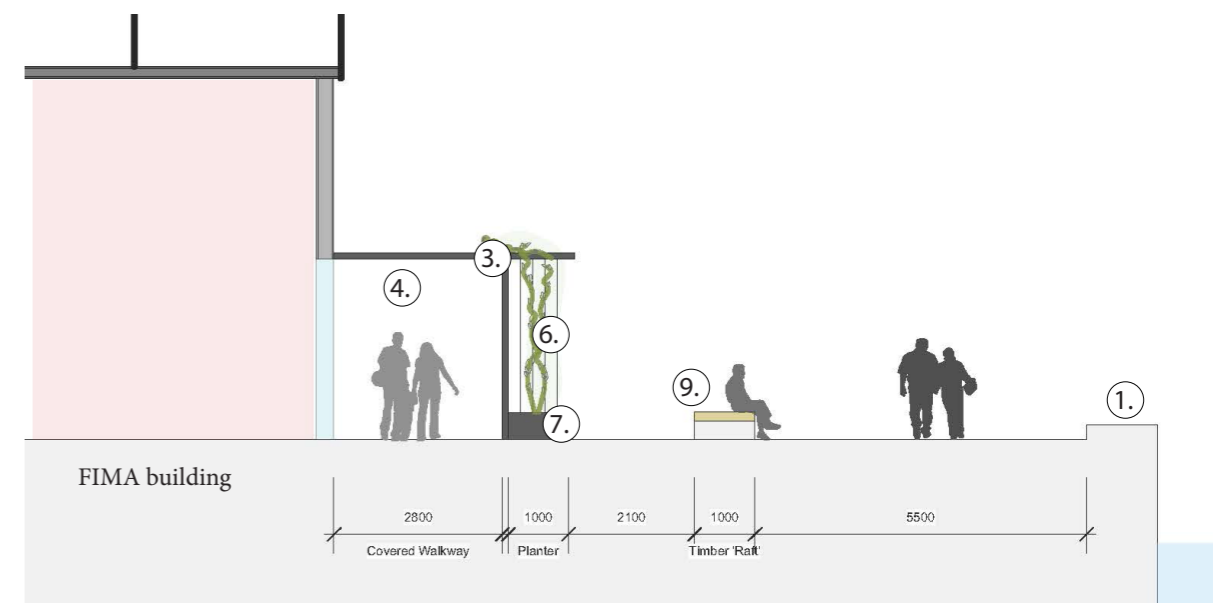

SECTION HH: Walkway

PLATYPUS  
33.8440° S, 151.2165° E

# 8 • WATERFRONT CONCEPTUAL VIEW + DESIGN EXAMPLES

- ① Existing concrete wharf
- ② Interpretive linemarkings
- ③ Steel structure to building edge
- ④ Covered weatherproof walkway with glass/perspex roof against building
- ⑤ Textile shade canopy to structure
- ⑥ Tensile wire connected to structure for green edge and canopy
- ⑦ Steel planters at the base of structure
- ⑧ Lighting conduits to steel structure
- ⑨ Timber and concrete 'raft' seats
- ⑩ Timber benches
- ⑪ Timber communal tables
- ⑫ Retail moveable furniture zone
- ⑬ Concrete planter pots

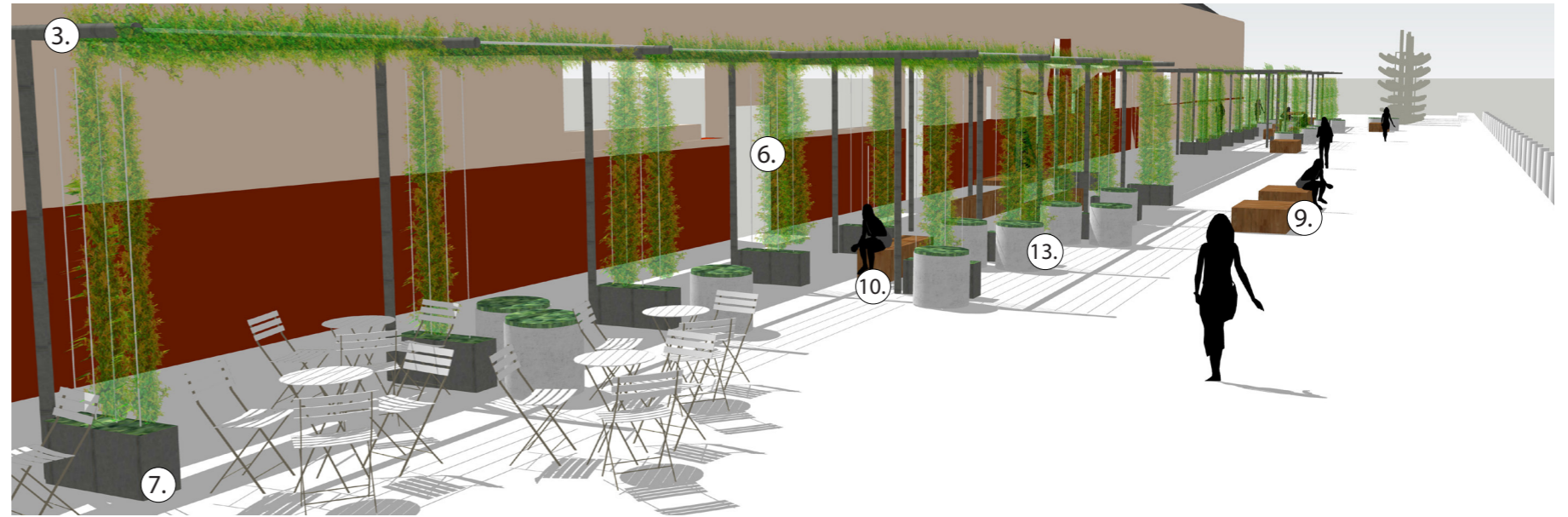

P L A T Y P U S  
33.8440° S, 151.2165° E

# 8 • WATERFRONT DESIGN EXAMPLES

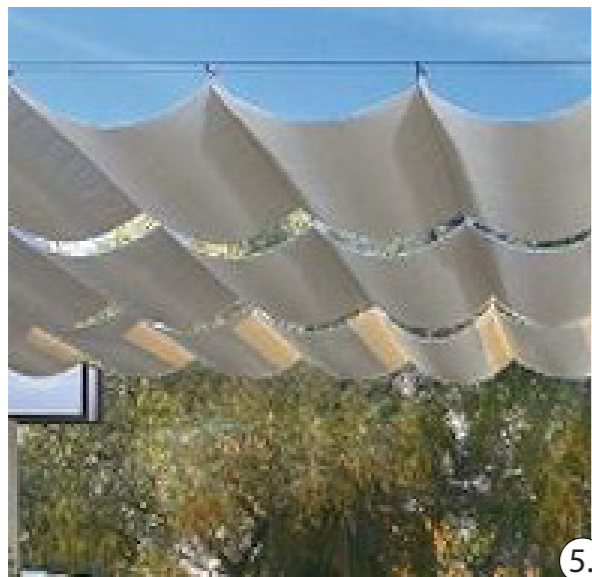
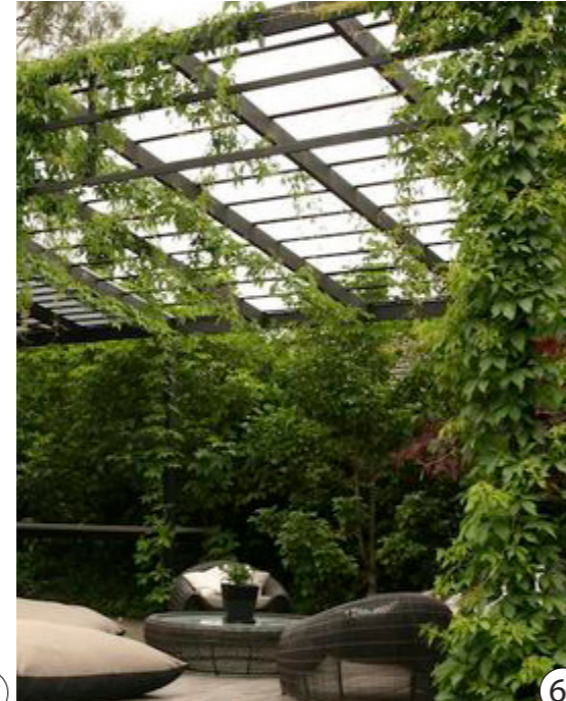

# 9 • UPPER CARPARK

## Upper Car Park

The existing Upper Car Park will be retained and used as parking for regular site users and for special events. The space will be refurbished as a shared vehicle/pedestrian zone with new lighting, balustrades, car safety stops and line markings. Parking will be controlled via a range of measures such as permits, time-limitations, meters or gates. Landscaping will be introduced to provide some heat and noise mitigation, with the retention of views from the neighbourhood a consideration in the selection of plantings.

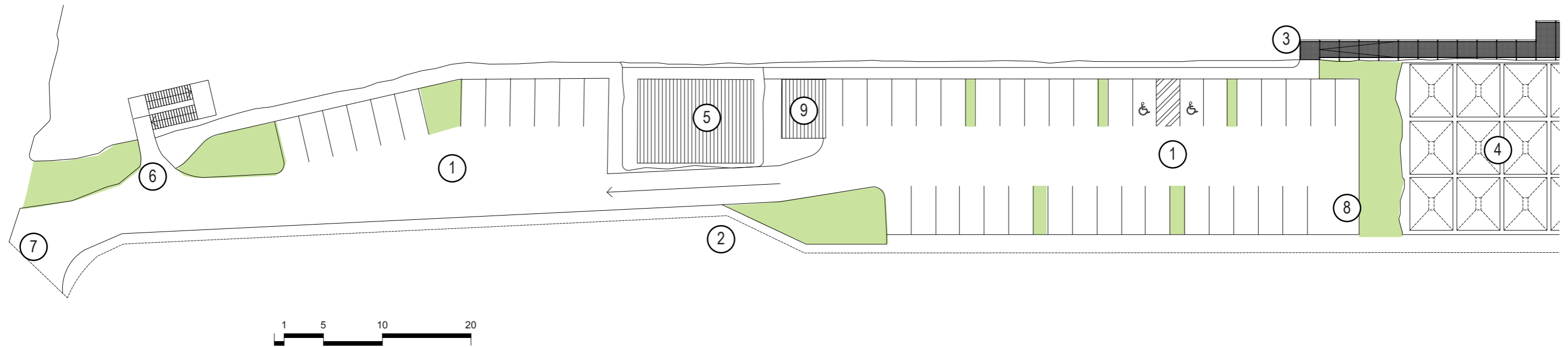

- ① Carpark
- ② Boundary line
- ③ Cliff walk from carpark to lift and stair access to Arrival Square
- ④ Coal Store building
- ⑤ Exhauster house (below)
- ⑥ Stair link to Northern Park
- ⑦ Entry to carpark and shared pedestrian zone from Kiara Close
- ⑧ Car turning bay
- ⑨ Existing Pol building

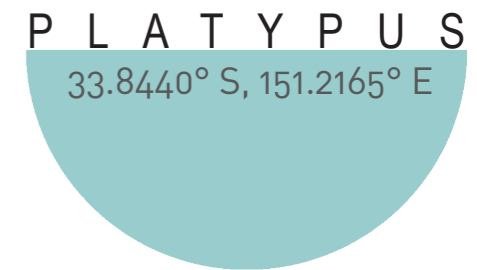

# 10 • NORTHERN PARK & PLAY AREA PLAN

## Northern park

The aim is to increase and enrich the current Northern Park through the addition of a small adventure playground, public bbq area, parkland and increased large tree shading. The adventure play draws inspiration from the significant level changes onsite and submariner narrative through forms, experiences and materials. Nature forest play is expressed through the embankment, dense planting and informal meandering pathways. Green parkland is introduced to the foreshore which references the industrial past of the site. At the north west corner, a pedestrian connection to the surrounding north and upper carpark is provided via a new stair.

1. New concrete stairs with nosings, tactiles + handrails
2. Enhanced mass planting
3. Decomposed granite gravel
4. Planter beds with existing planting
5. Additional dense tree planting
6. Steel shade structure with 2x public BBQs + communal table + seats
7. Submariners memorial zone - future scope of works
8. Local play area with shade to future detail
9. Seat/wall, new cladding over gabion wall
10. Balustrade
11. FRP Stairs with handrails
12. Bicycle racks fixed to concrete slab
13. Timber seating
14. Large fig tree in mass planting bed
15. Folded steel heritage interpretation panel fixed to concrete - acts as barrier
16. Access stairs to Northern Park from Kiara Close

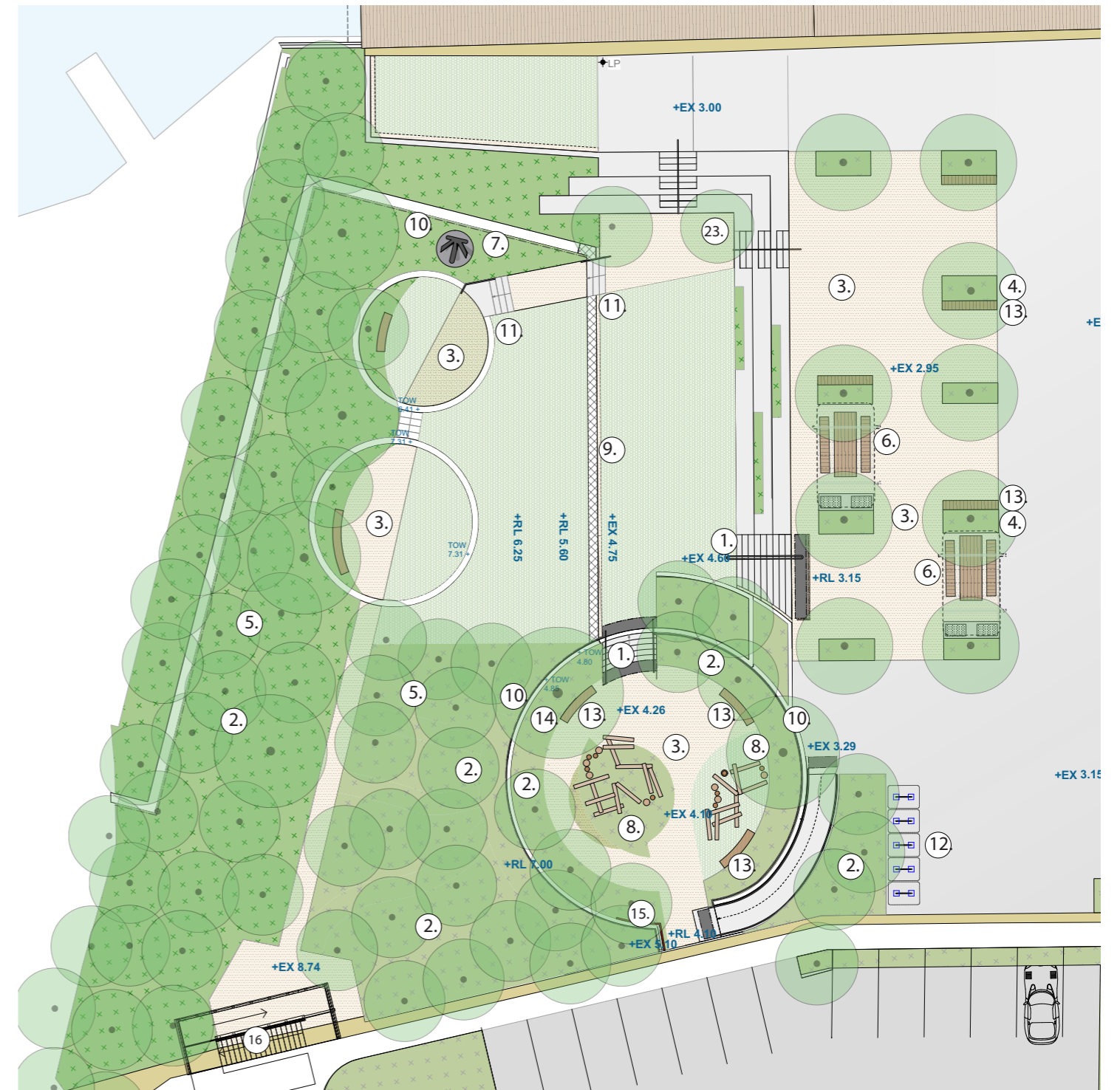

PLATYPUS

33.8440° S, 151.2165° E



ASPECT Studios™  
lahznimmo  
architects

# 11 • NORTHERN STAIRS PLAN

1:50

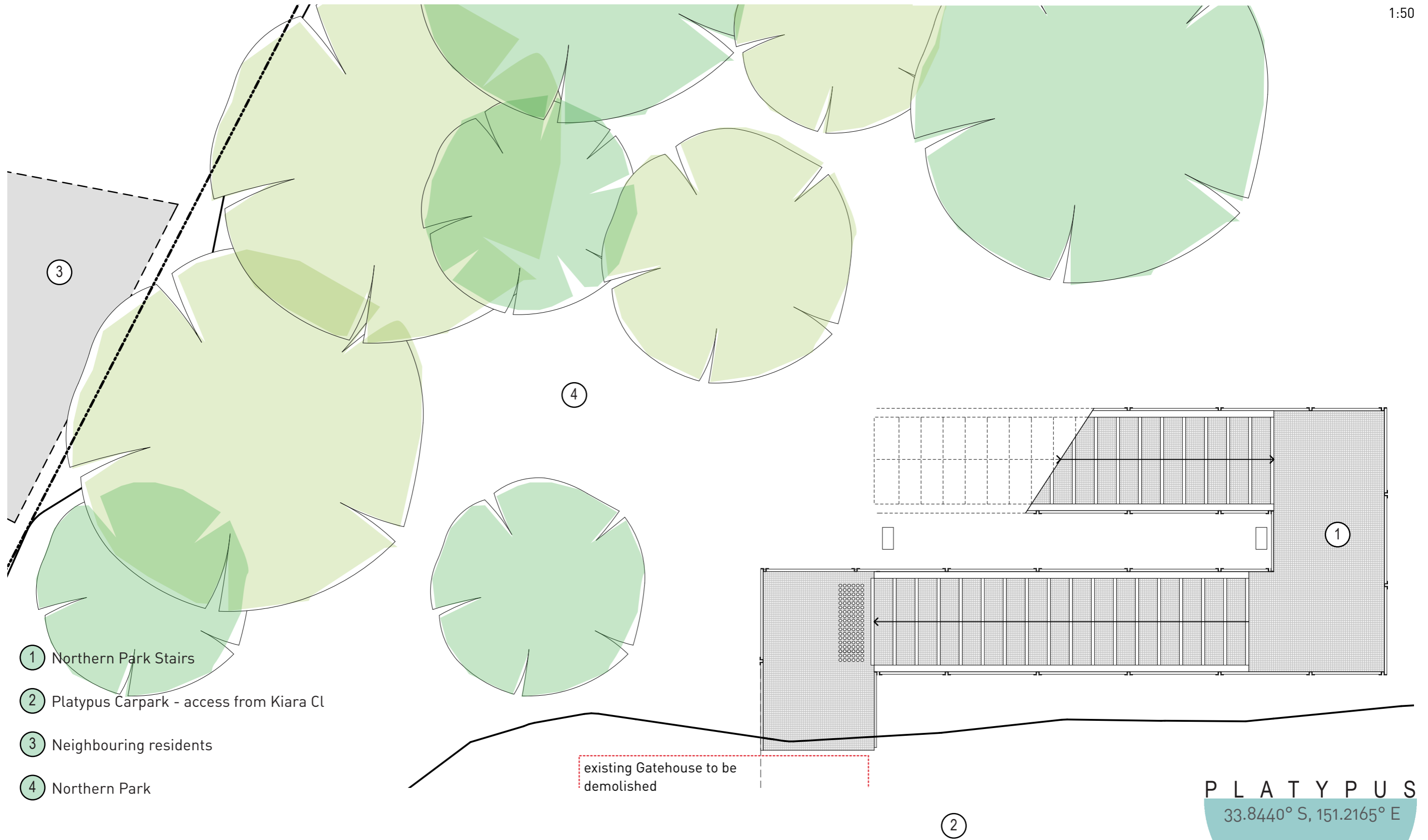

- ① Northern Park Stairs
- ② Platypus Carpark - access from Kiara Cl
- ③ Neighbouring residents
- ④ Northern Park

existing Gatehouse to be demolished

PLATYPUS  
33.8440° S, 151.2165° E

②

# 11 • NORTHERN STAIRS SECTION

1:50

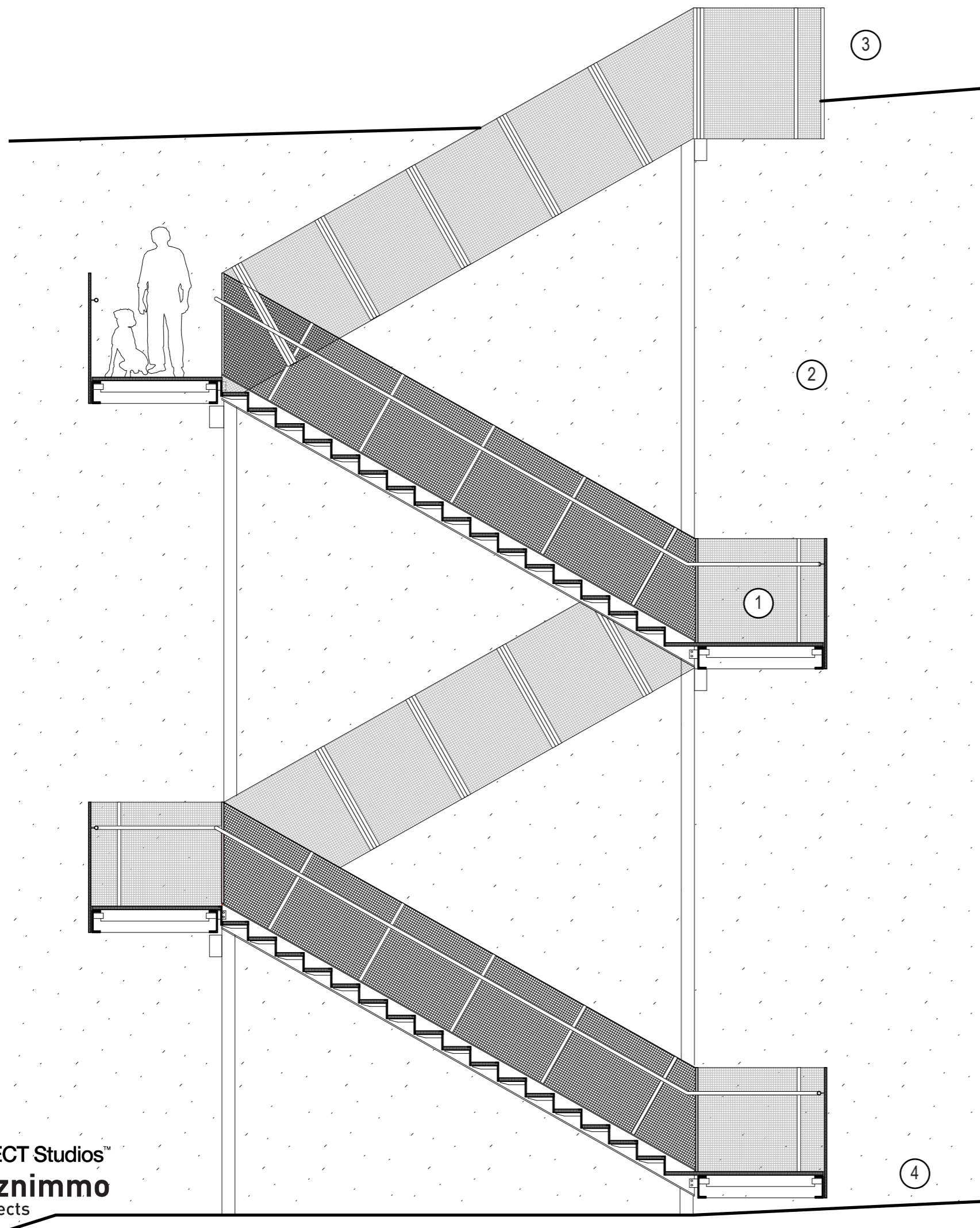

- ① Northern Park Stairs
- ② Existing sandstone and masonry cliff
- ③ Access from Kiara Cl and Platypus carpark
- ④ Northern Park

PLATYPUS  
33.8440° S, 151.2165° E



# 11 • NORTHERN STAIRS PERSPECTIVE

## New public circulation

The Northern stair will be the first in a series of 'clip-on' circulation elements that appear to cling to the sandstone cliff face.

Whilst acknowledging the existing industrial nature of the site, the elements should appear as a new clear addition to the site.

Colour is proposed to be applied to these elements, to highlight the public nature of the circulation, improve way finding and signal the new 'public park' role of the site.

The highly robust steel and coloured Fibre-reinforced plastic (FRP) structure is intended as a family of simple, lightweight and expressive components that are clearly new, but draws from the honest industrial tradition of tectonic construction. FRP has been used extensively throughout the Royal National Park in Sydney's south as durable and low maintenance coastal and bush boardwalks.

